

Mechanical SUS Stage

KUGE

KX-60



Model	KX-60
Dimension	60mm × 60mm
Travel Guide	Precise Crossed-Roller Guide
Drive Motor	5-phases Stepping Motor 0.75A/Phase
Working Length	± 10mm
Mechanical Drive Screw	Ball Screw $\phi 4$ Lead1
Resolution	1 μ m/pulse(Half step)
Repeatability	< $\pm 0.3 \mu$ m
Backlash	< 1 μ m
Lost Motion	< 1 μ m
Straight Direction	< 1 μ m/10mm
Maximum Speed	10mm/Sec
Weight	0.9kg

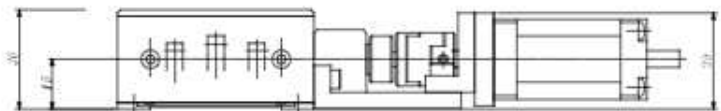
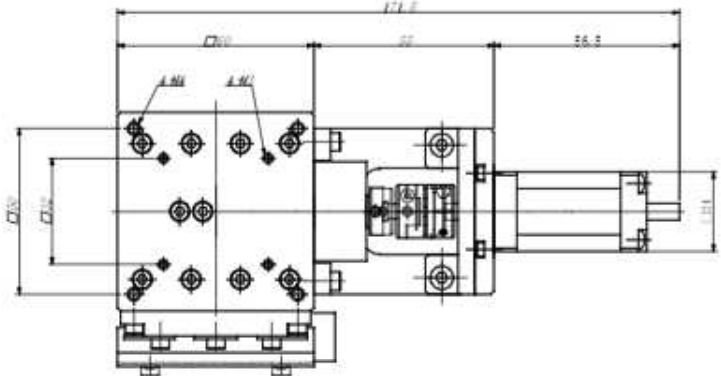
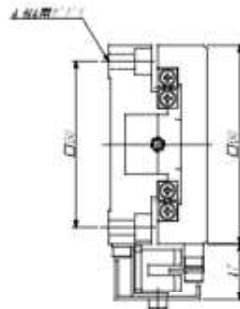

KX-100



Model	KX-100
Dimension	100mm × 100mm
Travel Guide	Precise Crossed-Roller Guide
Drive Motor	5-phases Stepping Motor 0.75A/Phase
Working Length	± 15mm
Mechanical Drive Screw	Ball Screw $\phi 6$ Lead1
Resolution	1 μ m/pulse(Half step)
Repeatability	< $\pm 0.3 \mu$ m
Backlash	< 1 μ m
Lost Motion	< 1 μ m
Straight Direction	< 1 μ m/10mm
Maximum Speed	10mm/Sec
Weight	2.0kg

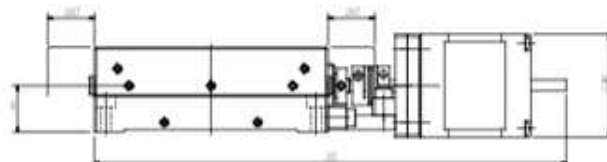
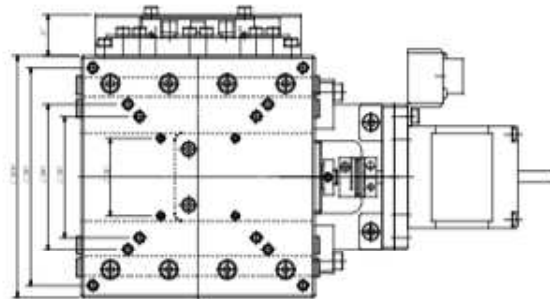
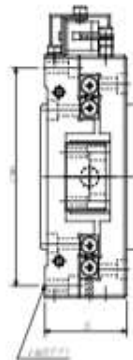

KX-125

Model	KX-125
Dimension	125mm × 125mm
Travel Guide	Precise Crossed-Roller Guide
Drive Motor	5-phases Stepping Motor 0.75A/Phase
Working Length	± 25mm
Mechanical Drive Screw	Ball Screw φ 6 Lead1
Resolution	1 μm/pulse(Half step)
Repeatability	< ± 0.3 μm
Backlash	< 1 μm
Lost Motion	< 1 μm
Straight Direction	< 1 μm/10mm
Maximum Speed	10mm/Sec
Weight	2.0kg

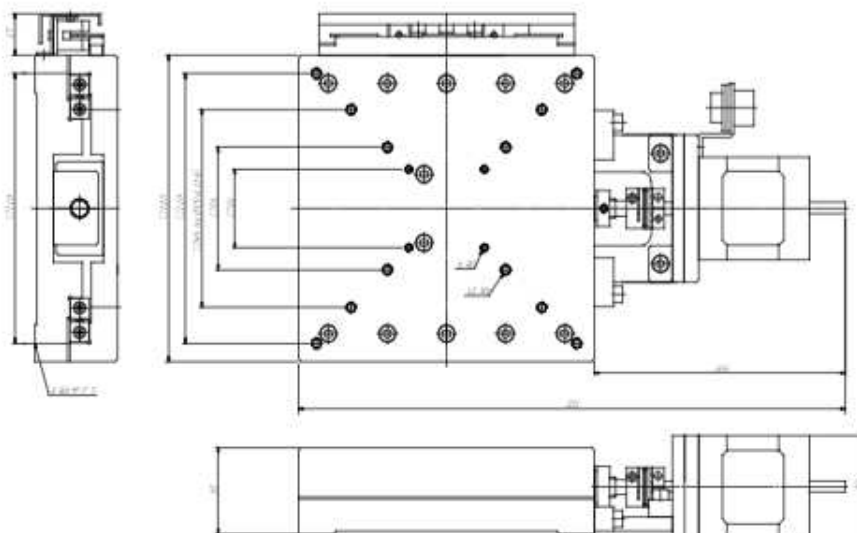

Stepping Motor Driver

2 Axes

KPO-100D- I - 2

4 Axes

KPO-100D- I - 4



Input Voltage	AC100V
Driving Current	0.75A,
Sensor	5V· 12V· 24V(/Axis)
Micro-Step Resolution	1· 2· 4· 5· 8· 10· 20· 40· 80· 16· 25· 50· 100· 125· 200· 250 div
Others	Current Limiter, Emergency Down, etc.



6 Axes

KPO-100D- II - 6

8 Axes

KPO-100D- II - 8

KUGE Co., Ltd.

1733-4 Ichigaochou Aoba-ku Yokohama Kanagawa-ken Japan 225-0024

tel +81-45-975-0031 fax +81-45-975-0032

URL : <http://kuge-co.com> E-mell : info@kuge-co.com

May 2010