

# NanoSpeed™ Broadband 1x2 Fiberoptic Switch

(patent pending)

## Product Description

The NS broadband Series 1x2 solid-state fiber optic switch connects optical channels by redirecting an incoming optical signal into a selected output optical fiber. This is achieved using patent pending non-mechanical configurations with solid-state all-crystal designs, which eliminates the need for mechanical movement and organic materials. The configuration eliminates waveplates for a wide wavelength operation. The NS fiberoptic switch is designed to meet the most demanding switching requirements of ultra-high reliability, fast response time, continuous switching and bidirectional operation.

The device can be driven by a cost effective circuit with 12V input voltage and 0-5 V control signal

## Features

- Solid-State high speed
- Ultra-high reliability
- Low insertion loss
- Compact size
- Low cost
- Low power consumption
- Simple driver

## Performance Specifications

NS Broadband 1x2 Switch	Min	Typical	Max	Unit
Operation Wavelength	780		2000	nm
Insertion Loss		0.8	1.2	dB
Cross Talk	20	25		dB
Polarization Dependent Loss		0.15	0.35	dB
IL Temperature Dependency		0.25	0.5	dB
Polarization Mode Dispersion		5	6	ps
Return Loss	45	50		dB
Response Time (Rise, Fall)			300	ns
Repetition Rate*	DC	5		KHz
Operating Temperature	-5		70	°C
Optical Power Handling		300	500	mW
Storage Temperature	-40		85	°C
Package Dimension		46.3x16.3x8.0		mm

\* Standard driver. High repetition rate (up to 500 KHz) is available with special circuit.



# NanoSpeed™ Broadband 1x2 Fiberoptic Switch

## Mechanical Dimensions (mm)

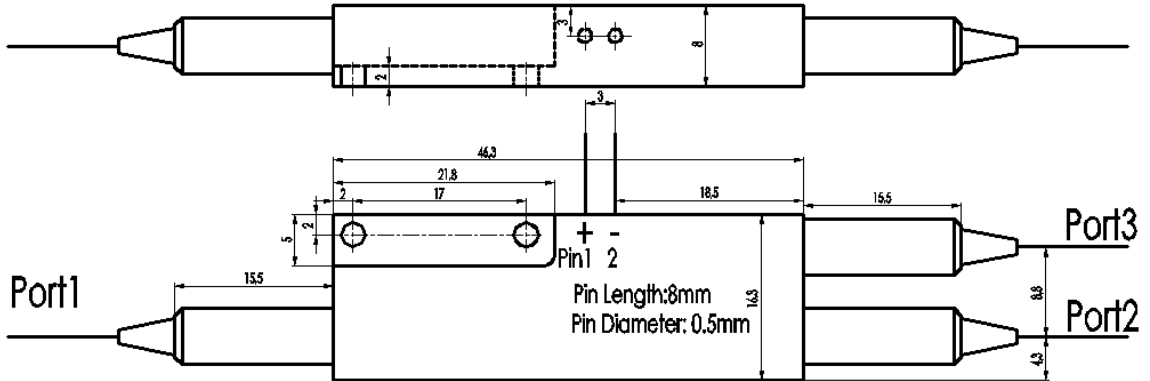

## Speed and Repetition Measurement

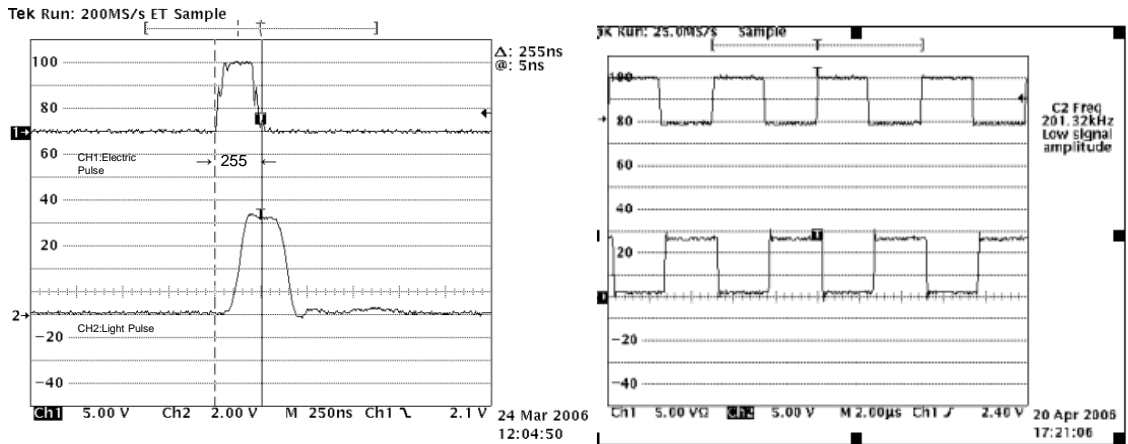

# NanoSpeed™ Broadband 1x2 Fiberoptic Switch

## Bandwidth Measurement at specified wavelength

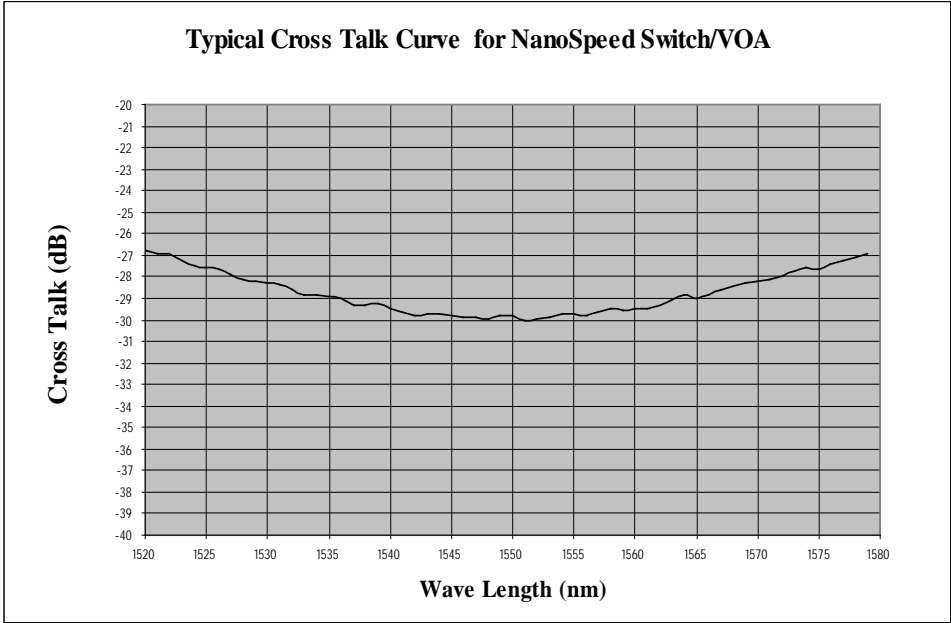

## Ordering Information

NSBW-	<input type="checkbox"/>	<input type="checkbox"/>	<input type="checkbox"/>	1	2	1	<input type="checkbox"/>	<input type="checkbox"/>	<input type="checkbox"/>
Type	Wavelength	Configuration	Package	Fiber Type		Fiber Length	Connector		
1x2=12	1260-1650=1			SMF-28=1 Special=0	Bare fiber=1 900um loose tube=3 Special=0	0.25m=1 0.5m=2 1.0 m=3 Special=0	None=1 FC/PC=2 FC/APC= 3 SC/PC=4 SC/APC=5 ST/PC=6 LC=7 Special=0		

